

Drawing Number 70080518-WSP-DRG-ETR-000206

← Tie-in to existing Leicester to Nuneaton Mainline

### HINCKLEY NATIONAL RAIL FREIGHT INTERCHANGE

Date: 14/10/2022  
 Paper Size: A0  
 Scale: 1:40 / 1:1000



Key:  
 Existing Ground Level (Green line)  
 Proposed Ground Level (Red line)

Note: the vertical limits of deviation provide for a variation in top of rail levels of +1.5m / -3m where permitted by site constraints.

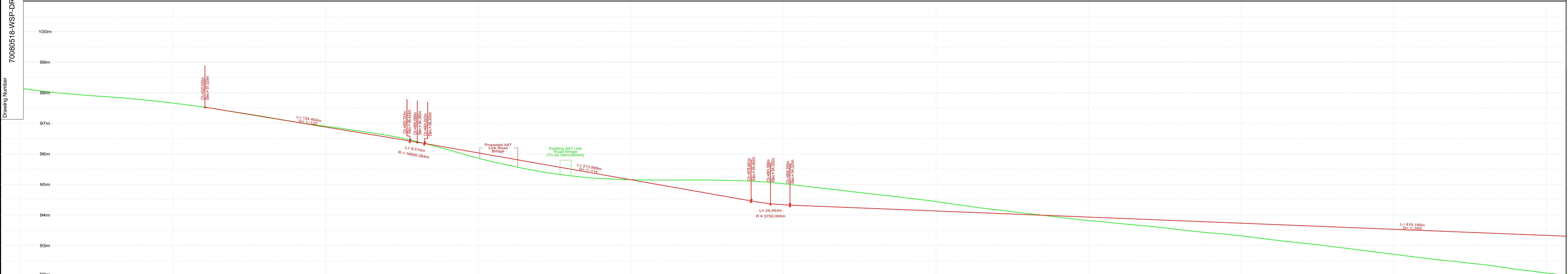

CHAINAGE (m)	500.000	520.000	550.000	570.000	600.000	630.000	660.000	690.000	720.000	750.000	780.000	810.000	840.000	870.000	900.000	930.000	960.000	990.000	
EXISTING LEVEL (m)	98.500	98.000	97.500	97.000	96.500	96.000	95.500	95.000	94.500	94.000	93.500	93.000	92.500	92.000	91.500	91.000	90.500	90.000	
PROPOSED LEVEL (m)	98.500	98.000	97.500	97.000	96.500	96.000	95.500	95.000	94.500	94.000	93.500	93.000	92.500	92.000	91.500	91.000	90.500	90.000	
VERTICAL SCHEMATIC	[Vertical curve symbols and data points]																		
HORIZONTAL SCHEMATIC	[Horizontal alignment symbols and data points]																		
EXISTING CANT (mm)	[Existing cant values]																		

### Runaround Long Section, Scale V 1:50 & H 1:1000, Datum 92m

Tie-in to existing Leicester to Nuneaton Mainline →

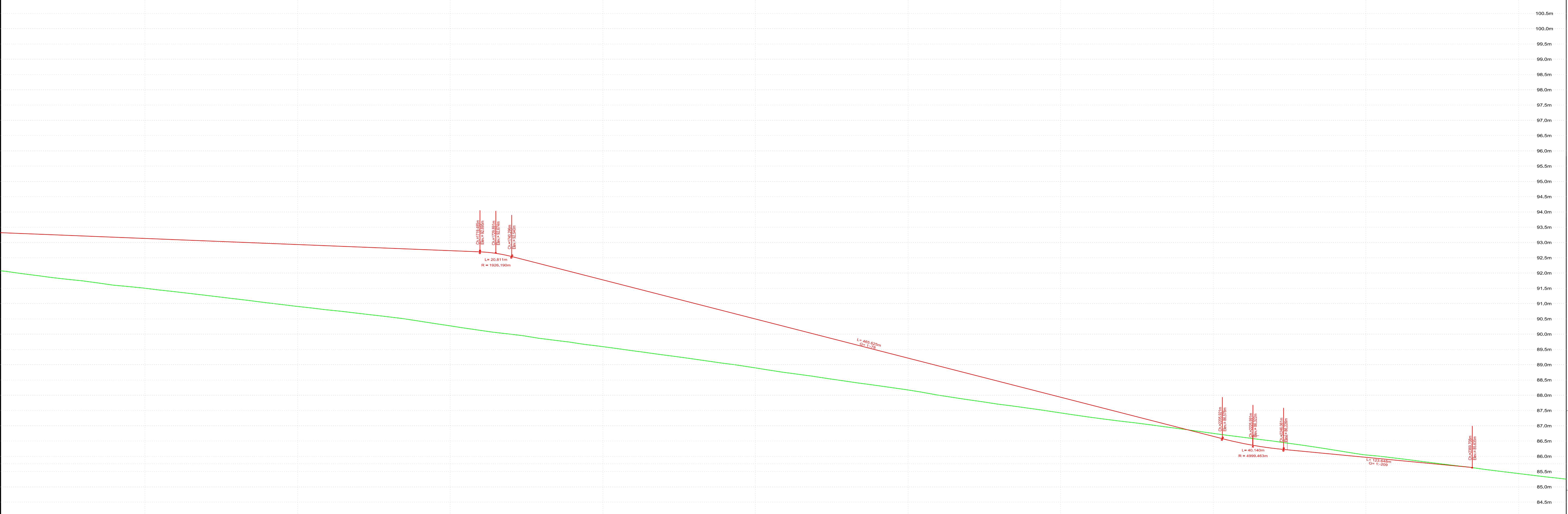

CHAINAGE (m)	1718.485	1740.200	1760.000	1780.000	1800.000	1820.000	1840.000	1860.000	1880.000	1900.000	1920.000	1940.000	1960.000	1980.000	2000.000	2020.000	2040.000	2060.000	2080.000
EXISTING LEVEL (m)	92.500	92.000	91.500	91.000	90.500	90.000	89.500	89.000	88.500	88.000	87.500	87.000	86.500	86.000	85.500	85.000	84.500	84.000	83.500
PROPOSED LEVEL (m)	92.500	92.000	91.500	91.000	90.500	90.000	89.500	89.000	88.500	88.000	87.500	87.000	86.500	86.000	85.500	85.000	84.500	84.000	83.500
VERTICAL SCHEMATIC	[Vertical curve symbols and data points]																		
HORIZONTAL SCHEMATIC	[Horizontal alignment symbols and data points]																		
EXISTING CANT (mm)	[Existing cant values]																		

### Runaround Long Section, Scale V 1:50 & H 1:1000, Datum 84m



Hinckley National Rail Freight Interchange

Illustrative Railport Sections Long Section

APFP Ref: 523(x)  
 Document Ref: 2.23.2  
 Drawing Number: 70080518-WSP-DRG-ETR-000206  
 Drawing Status: S4 - Final  
 Revision: 001  
 Drawn by: Georg Reef  
 Approved by: David Parry